

 **MBI[®]**



SD

SHEAR DISMANTLER



Mantovanibenne®

SD DISMANTLE
DESTROY
DISASSEMBLE

SD

SHEAR DISMANTLER

A special type of shear that is dedicated to vehicle dismantling and in height demolitions. Its narrow jaw design ensures great precision in selecting parts picked and moved while the powerful cylinder grants high cutting power. It is an optimal tool for scrapping professional to disassemble cars, trucks or wagons.

- The **optional blades and wire pads** make of the SD an extremely precise tool dedicated to **vehicle parts recycling**.



STANDARD BLADE

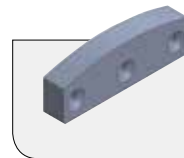

WIRE-CUTTING BLADE

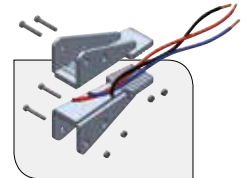

WIRE PADS

- The **continuous hydraulic rotation** enables **precise positioning** during in height demolitions and ground operations, while its robust components grant **high durability**.

- The **thin jaws** are designed for precision jobs, such as engine and gearbox extraction from vehicles.

- The long and straight blades allow **precise cuts**. All the blades are interchangeable and can be turned three times before replacement.

- The **compact and resistant structure** is manufactured with high-resistant steel to last in years.



TECHNICAL DATA

BT.SD.01

MODEL		SD12	SD20
EXCAVATOR WEIGHT	t	10-18	18-26
TOOL WEIGHT *	kg	950	1760
OPENING	mm	700	795
HEIGHT	mm	1800	2100
WORKING PRESSURE	bar	200-250	300-350
OIL FLOW	l/min	60-100	180-200

We are constantly improving our products and therefore we reserve the right to change the design and technical specifications without prior notice.

* Tool weight does include Mantovanibenne top bracket.

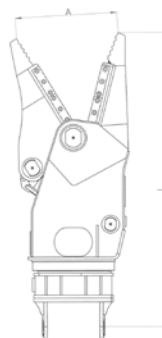

MODEL SD20

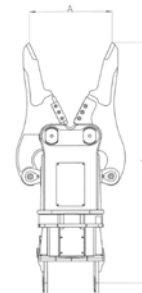

MODEL SD12

REF. 97900E 12/18 REV.01



Mantovanibenne s.r.l. - Mirandola (Mo) Italy - Tel. +39 0535 615811 - Fax +39 0535 615830
sales@mantovanibenne.com

www.mantovanibenne.com

